

### EPX-AD-ZIF33.YB

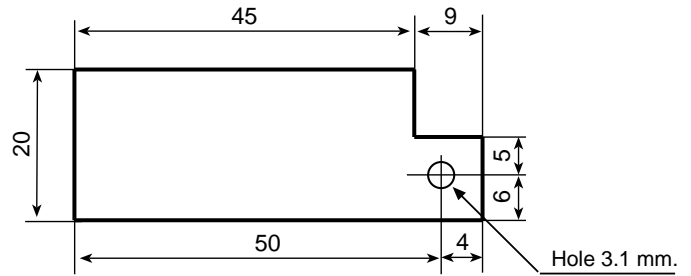
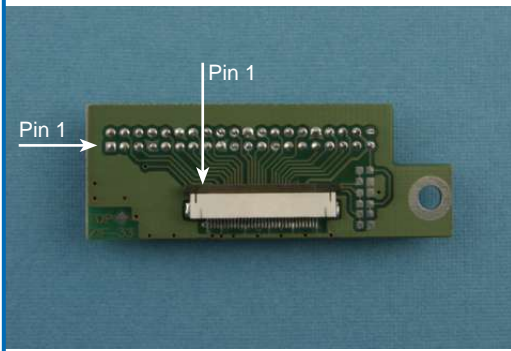

| Adapter <b>EPX-AD-ZIF33.YB</b> |         |                                 |
|--------------------------------|---------|---------------------------------|
| Housing pitch 2mm. 2x20 Pins   | Signal  | ZIF Header SMT 0.5 mm. - 33 Pos |
| 1                              | N.C.    |                                 |
| 2                              | N.C.    |                                 |
| 3                              | ENAB    | 27                              |
| 4                              | H Sync. | 3                               |
| 5                              | V Sync. | 4                               |
| 6                              | CLK     | 2                               |
| 7                              | Bus GND |                                 |
| 8                              | N.C.    |                                 |
| 9                              | N.C.    |                                 |
| 10                             | RE0     | 6                               |
| 11                             | RE1     | 7                               |
| 12                             | Bus GND |                                 |
| 13                             | RE2     | 8                               |
| 14                             | RE3     | 9                               |
| 15                             | RE4     | 10                              |
| 16                             | RE5     | 11                              |
| 17                             | Bus GND |                                 |
| 18                             | N.C.    |                                 |
| 19                             | N.C.    |                                 |
| 20                             | GE0     | 13                              |
| 21                             | GE1     | 14                              |
| 22                             | Bus GND |                                 |
| 23                             | GE2     | 15                              |
| 24                             | GE3     | 16                              |
| 25                             | GE4     | 17                              |
| 26                             | GE5     | 18                              |
| 27                             | Bus GND |                                 |
| 28                             | N.C.    |                                 |
| 29                             | N.C.    |                                 |
| 30                             | BE0     | 20                              |
| 31                             | BE1     | 21                              |
| 32                             | Bus GND |                                 |
| 33                             | BE2     | 22                              |
| 34                             | BE3     | 23                              |
| 35                             | BE4     | 24                              |
| 36                             | BE5     | 25                              |
| 37                             | Bus GND |                                 |
| 38                             | Bus VCC |                                 |
| 39                             | Bus VCC |                                 |
| 40                             | N.C.    |                                 |
|                                | Bus VCC | 28, 29, <b>30, 31</b>           |
|                                | Bus GND | 1, 5, 12, 19, 26, 33            |

Included FFC cable 33 pin - lenght 200 mm - pitch 0.5 mm  
The photos are purely indicative of the model and the connectors polarization.