

EPX-AD-ZIF40.Y2

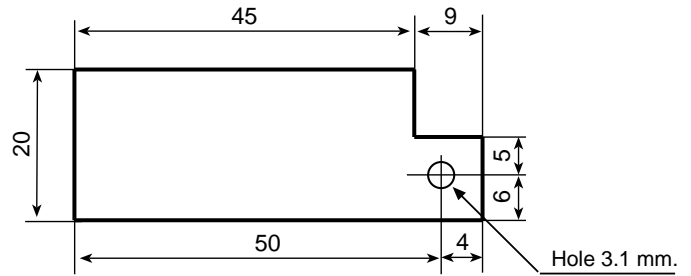
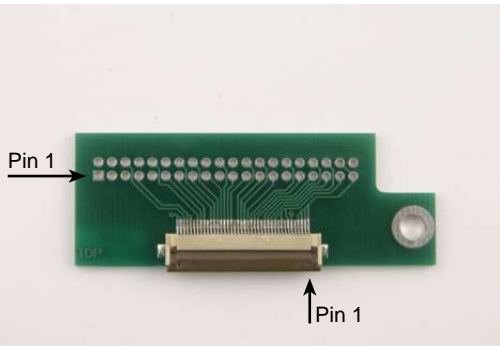

Signal Cable EPX-AD-ZIF40.Y2		
Housing 2x20 Pin - 2mm.	Signal	ZIF Header SMT 0.5 mm. - 40 Pos.
1	N.C.	
2	N.C.	
3	ENAB	6
4	H Sync	
5	V Sync	
6	CLK	38
7	Bus GND	
8	N.C.	
9	N.C.	
10	RE0	34
11	RE1	33
12	Bus GND	
13	RE2	32
14	RE3	30
15	RE4	29
16	RE5	28
17	Bus GND	
18	N.C.	
19	N.C.	
20	GE0	26
21	GE1	25
22	Bus GND	
23	GE2	24
24	GE3	22
25	GE4	21
26	GE5	20
27	Bus GND	
28	N.C.	
29	N.C.	
30	BE0	18
31	BE1	17
32	Bus GND	
33	BE2	16
34	BE3	14
35	BE4	13
36	BE5	12
37	Bus GND	
38	Bus VCC	
39	Bus VCC	
40	N.C.	
	Bus VCC	1, 2, 3, 4
	Bus GND	7, 9, 11, 15, 19, 23, 27, 31, 36, 37, 39, 40

Included ZIF cable 40 pos. lenght 200 mm.

The photos are purely indicative of the model and the connectors polarization.